

**INSTRUCTIONS FOR USE AND INSTALLATION  
ROLLER GRILLS  
RG 5 / RG 7 / RG 9 / RG 11**

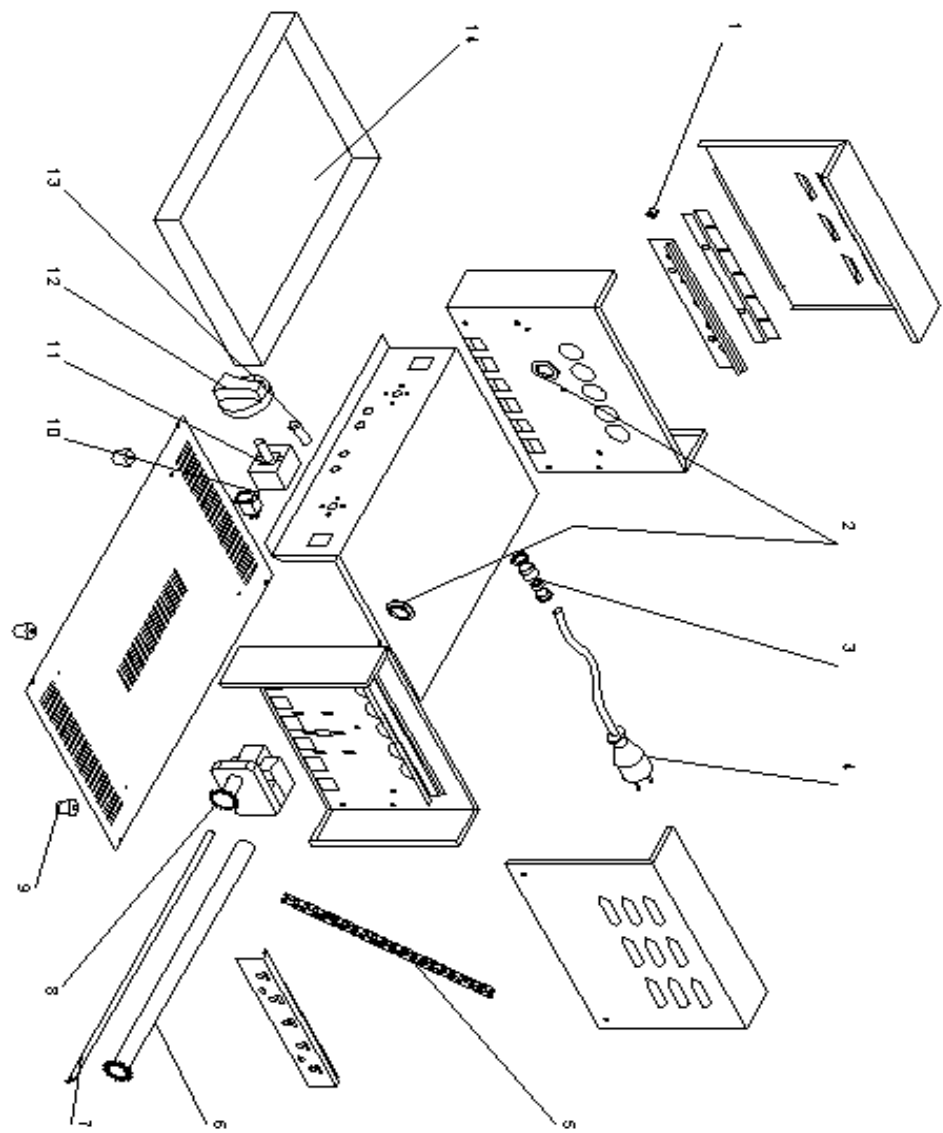

**Made in France**



## ROLLER GRILLS RG 5 / RG 7 / RG 9 / RG 11

Nomenclature **RG 11**  
Spare parts **RG 11**

Congratulations for the acquisition of this upmarket appliance made in France. You chose an appliance which alloys the best technical qualities with a big user-friendliness. We wish you the biggest contentment

### 1. SECURITY INSTRUCTIONS

Please respect these instructions scrupulously to avoid any risk of fire, electric shock, scald or other wounds and damage. During the use of this appliance, fundamental circumspection of security must always be noticed, such as:

Rep	Code	Qty	Pièce	Spare part
1	A09003	4	Steatite	Steatite
2	B06029	22	Bague téflon	Teflon ring
3	A10002	1	Serre cable	Cord closer
4	C03013	1	Cordon avec prise	Cord with plug
5	B07023	1	Chaine	Chain
6	B01005	11	Tube + pignon	Gear wheel
7	D02037	11	Résistance blindée	Heating element
8	A03038	1	Moteur	Motor
9	A13003	4	Pied	Foot
10	A07025	1	Interrupteur	Switch
11	A04006	2	Régulateur	Regulator
12	A14078	2	Bouton	Knob
13	A08003	2	Voyant orange	Orange pilot light
14	27009SE	1	Plat	Tray

- Take into account the instructions to be systematically kept with the appliance.
- Install the appliance always in instructions respect. A 10 cm distance minimum with the partition or the wall is necessary.
- Protect the appliance from direct light of the sun, frost and humidity.
- Never leave the appliance within the reach of children or disabled persons without surveillance.
- Never move the appliance when it is working or when the surfaces of cooking are still hot..
- Check that the appliance is definitely off before connecting it up or disconnecting it.
- Do not touch the hot surfaces of the appliance. The temperature of the hot surfaces can be very important when the appliance is working. Always use handles and control knobs.
- Do not use the appliance for other functions than determined use.
- Do not leave the cord of electrical feeding in the contact of hot surfaces.
- The appliance should not be used close to combustible materials.
- During use, look after not to obstruct hearings of aeration of the appliance
- Never use metal utensils which could damage the coating of the cylinders.
- Never operate the appliance without the sauce tray under the rollers
- To avoid any electric shock, never plunge the appliance, the cord or plug in water or quite other liquid.
- If the cord is harmed, it must be replaced by the producer, his after sale service or persons of similar skills to avoid any risk.
- Entrust compensations only to a skilled person.
- Use only spare parts of origin.
- At the end of cooking, before cleaning the appliance, do not forget to disconnect it.

## 2. CONTENTS OF CARDBOARD PACKAGING

Device: A roller grill

Accessories:- A sauce drip tray

- The present note

See exploded views for each roller grills at the end of the document

## 3. CONFORMITY OF USE

Use the device only to keep warm precooked sausages.

## 4. WAY OF FUNCTIONING

These roller grills are available in four different versions. Depending on the versions, you will be able to reheat up to 30 sausages. For models RG 5 and RG 7, you have one power control system enabling you to set the temperature of the cylinders.

Models RG 9 and RG 11 come with two independent power control systems, which enable to have two independent heating areas. The right knob controls the front area and the left one is for the rear heating area.

The running heating areas are indicated by the pilot lights.

To turn on and off the appliance, there is a switch.

To turn on the device, press the switch (n°3 on picture), just turn on the power control knob (n°2 on picture) on the wished position. If you want a quick preheating, set it on maximum position. The orange pilot light ignites (n°1 on picture) during heating. When orange pilot light switches off, the device is ready for cooking.

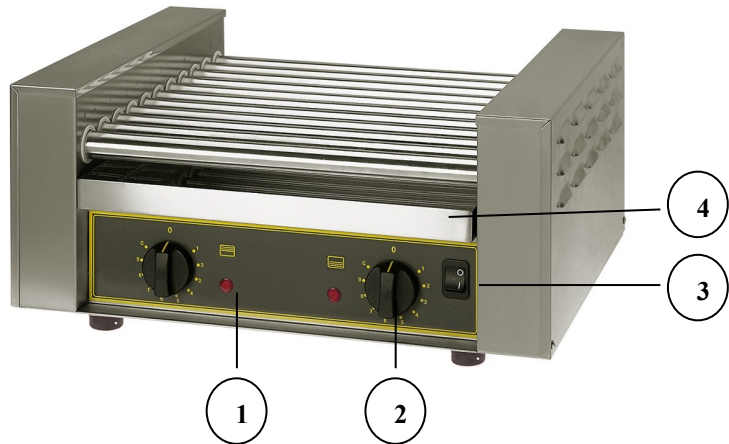

1 Pilot light

2 Power control knob

3 On/off switch

4 Sauce drip tray

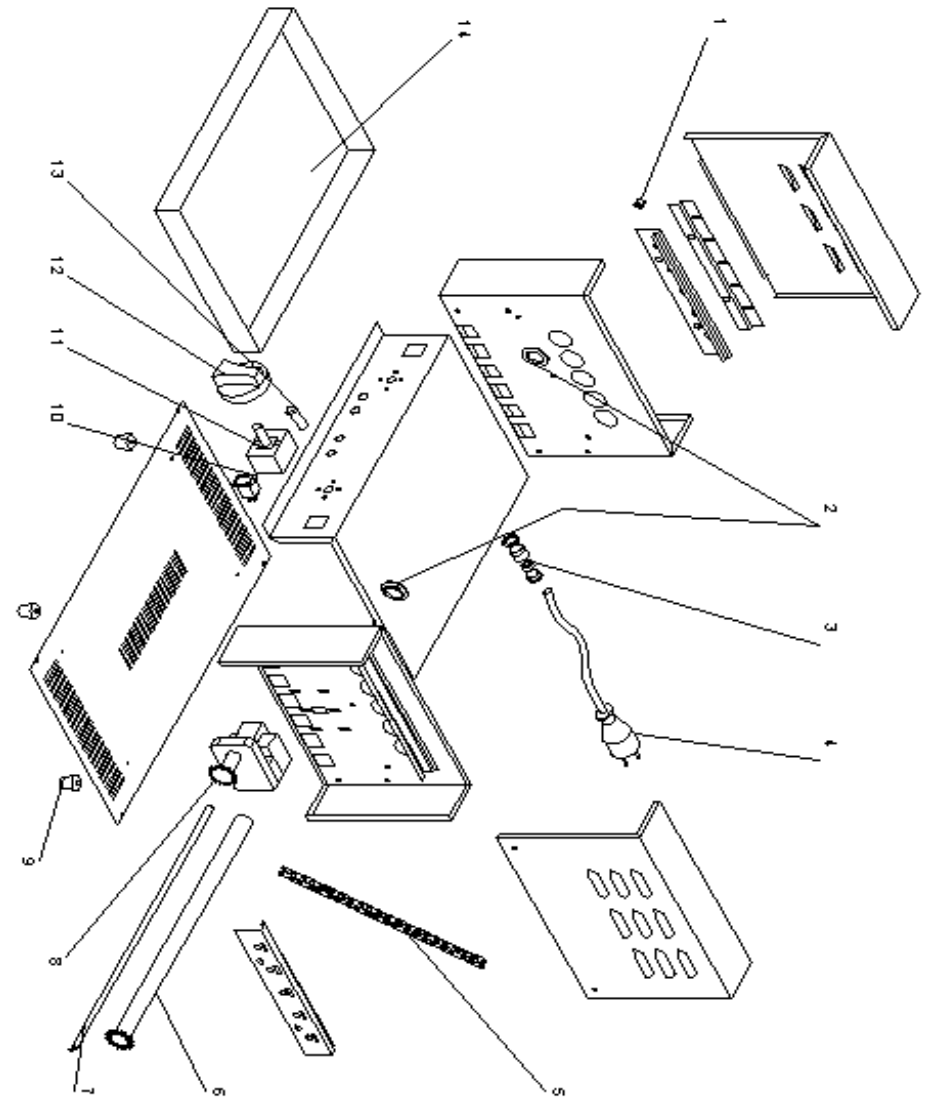

Nomenclature **RG 9**  
Spare parts **RG 9**

Rep	Code	Qty	Pièce	Spare part
1	A09003	4	Steatite	Steatite
2	B06029	18	Bague téflon	Teflon ring
3	A10002	1	Serre cable	Cord closer
4	C03013	1	Cordon avec prise	Cord with plug
5	B07011	1	Chaine	Chain
6	B01005	9	Tube + pignon	Gear w heel
7	D02037	9	Résistance blindée	Heating element
8	A03038	1	Moteur	Motor
9	A13003	4	Pied	Foot
10	A07025	1	Interrupteur	Sw itch
11	A04006	2	Régulateur	Regulator
12	A14078	2	Bouton	Knob
13	A08003	2	Voyant orange	Orange pilot light
14	27009SE	1	Plat	Tray

## **5. FUNCTIONING / MANIPULATION**

### **a) Installation / assembly:**

- Unpack carefully the device of its packaging.
- Place the roller grill on a plane and heatproof surface.
- Never place the device near a wall or near a partition makes of combustible materials even if it is very well isolated.
- A distance of minimum 10 cm with the partition or the wall is necessary.
- remove the protective film from the sauce drip tray and install it under the cylinders.

### **b) First starting:**

Before the first use, clean the heating cylinders with water and some dishwashing liquid. The use of detergent is possible as long as it is not excessively aggressive. Then wipe with a cloth dipped in oil.  
Be sure to use only sausages designed for this type of use so that they maintain their attractive look during heating.  
However, because sausages are never uniform, the parts in contact with the rollers tend to brown faster than the remainder of the sausage.

### ***First cleaning***

Clean the device before the first use. (See. 6 Cleaning)

### ***Connection of the device***

- Check that the tension and the frequency of the electricity network suit to the values indicated on the descriptive plate.
  - Make sure that every control knob is positioned on 0.
  - Check that neither the cord nor the plug are damaged
- Unwind completely the electric power cable and connect it in a plug connected with the earth.
- The device is connected.

**NB:** in case of connection of the device in a plug without earth protection or directly on the electricity network, confide its connection to a qualified person .

### c) Use of device :

#### **Elements of command and display**

Command/Display	Function
Power control knob (n°2 on picture)	Temperature setting
Orange pilot light (n°1 on picture)	Machine is heating (pilot light on) Temperature reached (pilot light off)
On/off switch (n°3 on picture)	On/off

#### **Putting on**

Press the switch on/off (n°3 on picture)

Turn on the power control knob (n°2 on picture) on the wished position: the orange pilot light (n°1 on picture) ignites.

For a quick preheating, set the power control knob on maximum position.

Once orange pilot light (n°1 on picture) is off, the machine reached the wished temperature.

For a continuous heating, select position C on power control knob.

#### **Temperature setting**

Set the temperature by positioning the power control knob (n°2 on picture) to the desired temperature. The orange pilot light (n°1 on picture) switches on if a higher level of temperature is required and switches off when the same is reached.

During heating, do not reduce the power so as to avoid the sausages shrinking and taking on a wrinkled look.

#### **Stopping the appliance**

Set power control knob (n°2 on picture) and the switch (n°3 on picture) on 0: the appliance is no longer functioning.

Let the device cool.

Disconnect the power cable.

Clean the appliance. (see 6. Cleaning)

### d) Breakdown / repair:

In case of breakdown or of damaged part, please call your after-sales service and confide any technical operation to qualified person.

When you contact the after-sales service of your distributor or your store, give him the complete reference of your device (commercial name, type and serial number). This information appears on the visible descriptive plate behind the device.

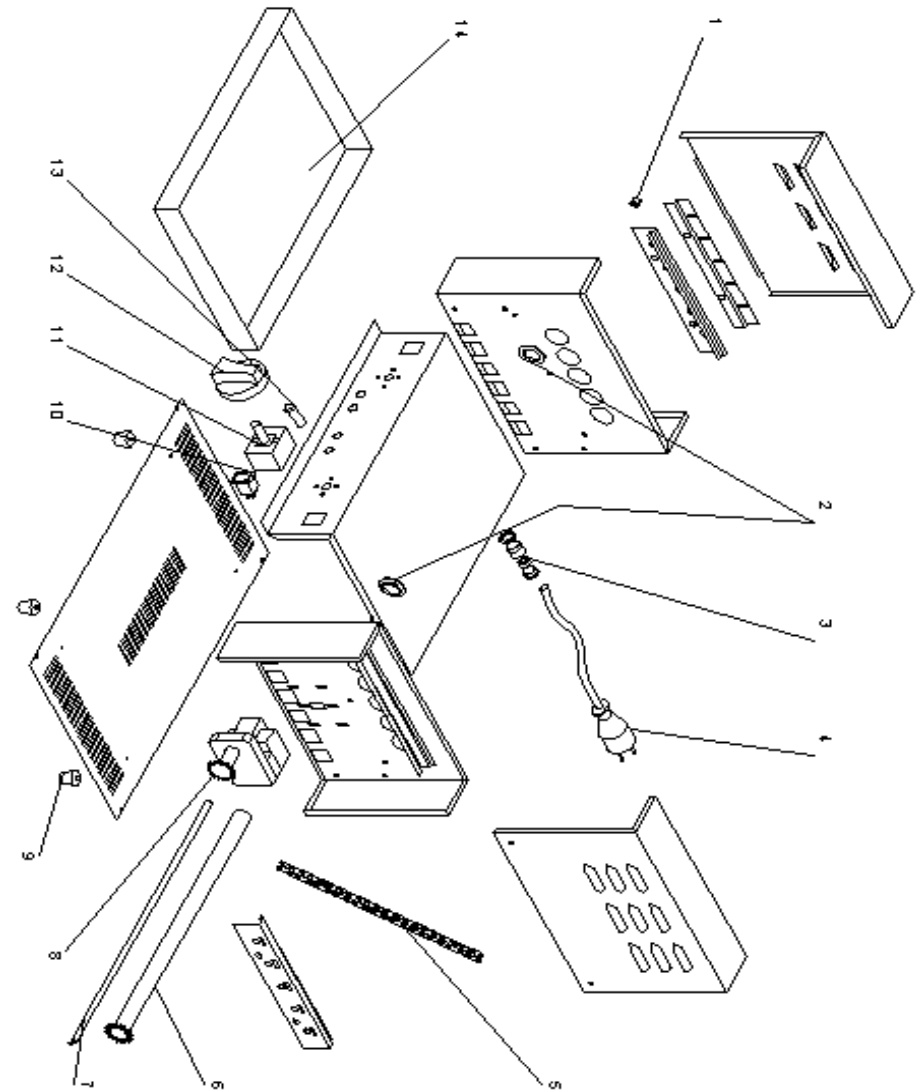

Nomenclature **RG 7**  
Spare parts RG 7

Rep	Code	Qty	Pièce	Spare part
1	A09003	2	Steatite	Steatite
2	B06029	14	Bague téflon	Teflon ring
3	A10002	1	Serre cable	Cord closer
4	C03013	1	Cordon avec prise	Cord with plug
5	B07010	1	Chaine	Chain
6	B01005	7	Tube + pignon	Gear w heel
7	D02037	7	Résistance blindée	Heating element
8	A03038	1	Moteur	Motor
9	A13003	4	Pied	Foot
10	A07025	1	Interrupteur	Sw itch
11	A04006	1	Régulateur	Regulator
12	A14078	1	Bouton	Knob
13	A08003	1	Voyant orange	Orange pilot light
14	27008SE	1	Plat	Tray

## 6. CLEANING AND MAINTENANCE

Disconnect the device.

- Let cool completely the device before any technical intervention or cleaning.
- Only use non-abrasive products, clean regularly the external walls of your device with warm water and wash liquid: avoid the abrasive towelling. Rinse your device with a wet sponge.
- For better cleaning, perform it when the cylinders are still hot. To do this, turn the power control knob to position C and clean the cylinders with a damp cloth. Wipe the cylinders from the ends toward the center so as not to push grease into the Teflon rings
- Never clean the device under a water jet, the infiltrations would risk to damage it in a irreparable way.
- Never immerse the device, the cord or the plug in the water or quite other liquid to avoid any electric shock.
- During a prolonged non-use, we recommend you strongly to keep the device shielded from the humidity.

## 7. TECHNICAL SPECIFICATIONS

Models	RG 5	RG 7	RG 9	RG 11
<b>Outside dimensions mm</b>	550x320x245	550x320x245	550x460x245	550x460x245
<b>Weight</b>	12.5 Kg	14 Kg	18.5 Kg	20 Kg
<b>Power</b>	625 W	875 W	1125 W	1375 W
<b>Capacity (sausages)</b>	12	18	24	30
<b>Nb elements</b>	5	7	9	11
<b>Current</b>	3 A	4 A	5 A	6 A
<b>Voltage</b>	220-240 V ~	220-240 V ~	220-240 V ~	220-240 V ~

Wires colours correspondence

Phase  
Neutral  
Earth

Brown / Black / Grey  
Blue  
Yellow-Green

## **8. NORMS AND LEGALS DISPOSALS**

The device is conform to :

IEC/EN 60335-1  
IEC/EN 60335-2-48  
EN 55014-1 + 55014-2  
EN 61000-3-2 + 61000-3-3

## **ELIMINATION OF THE ELECTRIC AND ELECTRONIC WASTE**

The device respects the directives:

2002/96/CE ( DEEE) N°34270064800021  
2002/95/CE ( ROHS)  
2066/95 CE  
2004/108 CE



### **Reach rule**

Never put the device among household waste.  
The device must be put down in a centre of recycling for the electric equipments.

The materials of the device are indeed reusable. By eliminating correctly the electric and electronic wastes, the recycling and quite other shape of re-use of worn equipments, you participate in a significant way in the environmental protection.

For any information about the collection of electric and electronic waste, please contact your distributor.

## **10. GUARANTEE**

### **Conditions of guarantee**

The guarantee applicable to any device is the commercial guarantee of the distributor or the retailer. Please contact the store where you bought your device to know the precise conditions.

The guarantee grants no right for damages.

The dispositions which follow are not exclusive of the profit of the legal guarantee planned by articles 1641 and following ones of the Civil code relative to the defects and the latent defects.

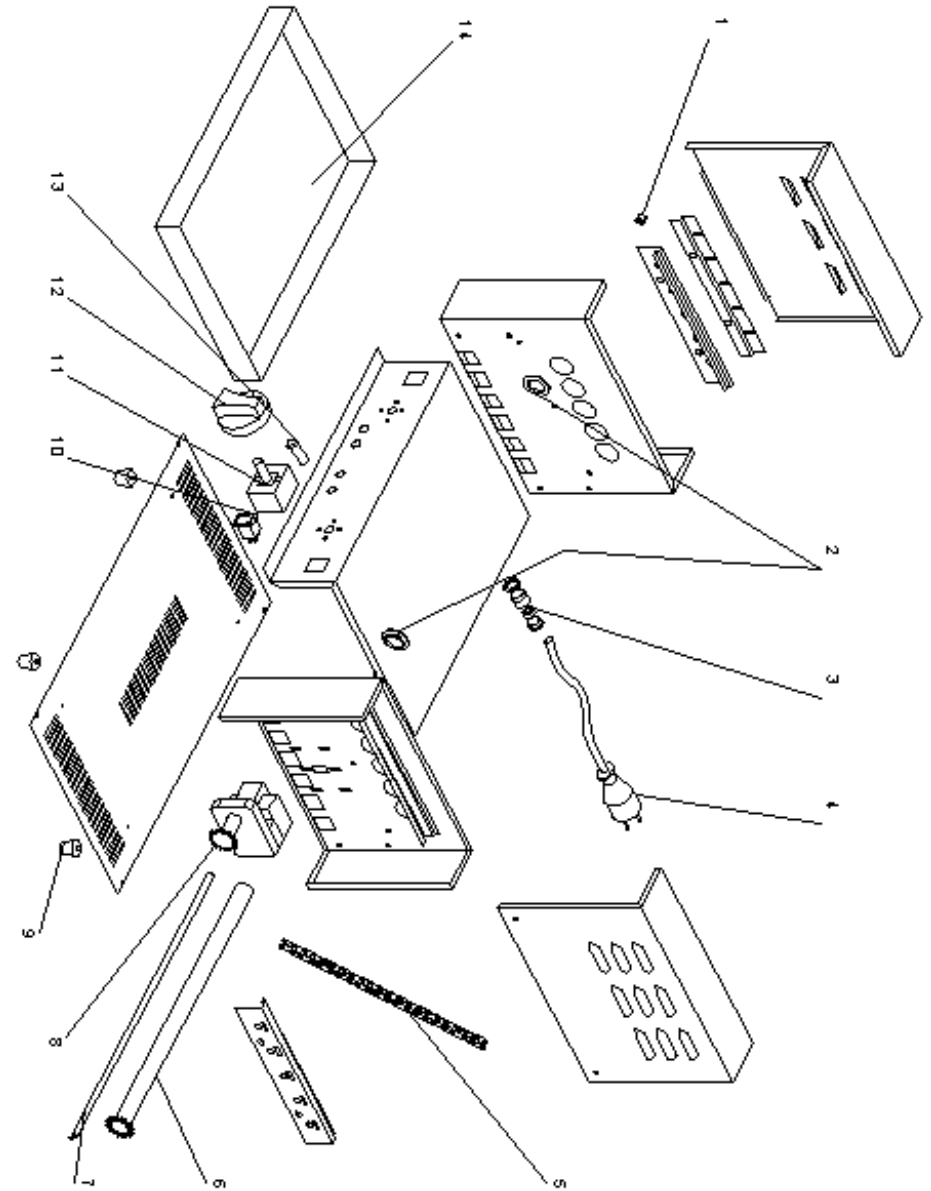



Nomenclature RG 5  
Spare parts RG 5

Rep	Code	Qty	Désignation	Spare part
1	A09003	2	Steatite	Steatite
2	B06029	10	Bague téflon	Teflon ring
3	A10002	1	Serre cable	Cord closer
4	C03013	1	Cordon avec prise	Cord with plug
5	B07006	1	Chaine	Chain
6	B01005	5	Tube + pignon	Gear wheel
7	D02037	5	Résistance blindée	Heating element
8	A03038	1	Moteur	Motor
9	A13003	4	Pied	Foot
10	A07025	1	Interrupteur	Switch
11	A04006	1	Regulateur	Regulator
12	A14078	1	Bouton	Knob
13	A08003	1	Voyant orange	Orange pilot light
14	27008SE	1	Plat	Tray

**Exclusion clauses of the guarantee**

**Bad installation and bad maintenance, in particular if they do not respect current regulations or instructions appearing in this user guide.**

Cannot benefit from the guarantee the repairs required as a result of false operations, of inappropriate use, of carelessness or of excess loads of the device, as well as those resulting from variations of the power supply, over tension or from defective installations.

The damage due to shocks, bad weather is not flatware by the guarantee. The material travels at the risks of the user; in case of delivery by carrier, the consignee has to have reservations towards the carrier before any delivery of the device.

The guarantee comes to an end in case of intervention, of repair, of modification by no qualified persons, or of use in inappropriate purposes.

